



## 44 Clos Cwm Creunant, Pontprennau, Cardiff, CF23 8LA

---

4 Bed • 3 Bath • EPC C

**£2,150 pcm**

# 44 CLOS CWM CREUNANT, PONTPRENNAU, CARDIFF, CF23 8LA

---



*Stunning 4 BED DETACHED in Pontprennau! Features a BRAND NEW ENSUITE, MODERN KITCHEN, CONSERVATORY & DRIVEWAY. Close to top schools, parks & excellent transport links. Ideal for family living in a sought-after area!*

# STEP INSIDE

---

Welcome to this beautiful 4-bedroom detached home situated in the highly desirable Pontprennau area of Cardiff. This property boasts a range of impressive features, including a brand new ensuite shower room, a modern family bathroom, and a stunning conservatory that floods the home with natural light. The stylish kitchen, equipped with a range cooker, is perfect for culinary enthusiasts, while the ample living spaces—including a lounge, dining room, and breakfast room—offer flexibility for family living or entertaining.

Pontprennau is renowned for its excellent local amenities, including a selection of highly regarded schools, parks, and easy access to transport links, making it an ideal location for families and professionals alike. Enjoy the tranquillity of semi-rural living while being just a stone's throw from Cardiff city centre and all its vibrant offerings.

Additional features such as double glazing throughout, a convenient cloakroom, a driveway, and a garage ensure this home is both functional and stylish. Don't miss your chance to secure this fantastic rental opportunity, perfect for modern family life!







## Property Details

Property Type: **Detached**

Bedrooms: **4**

Bathrooms: **3**

Floor Area: **581 sq ft**

EPC Rating: **C**

## Energy Performance

Current Rating

**C**

Potential Rating

**B**

## Key Features

- Brand New ensuite shower room
- All double glazed
- Modern Kitchen with Range Cooker
- Dining room
- Lounge
- Brand new family bathroom
- Conservatory
- Driveway and garage
- Breakfast room
- Cloakroom

# Floor Plans



44 Clos Cwm Creunant, Pontprennau, Cardiff, CF23 8LA



Floor plan is for illustrative purposes only. Not to scale.

## Property Specifications

Total Floor Area: **581 sq ft**

Habitable Rooms: **3**

Built Form: **Mid-Terrace**

Construction: **England and Wales: 1991-1995**

# First Floor



44 Clos Cwm Creunant, Pontprennau, Cardiff, CF23 8LA

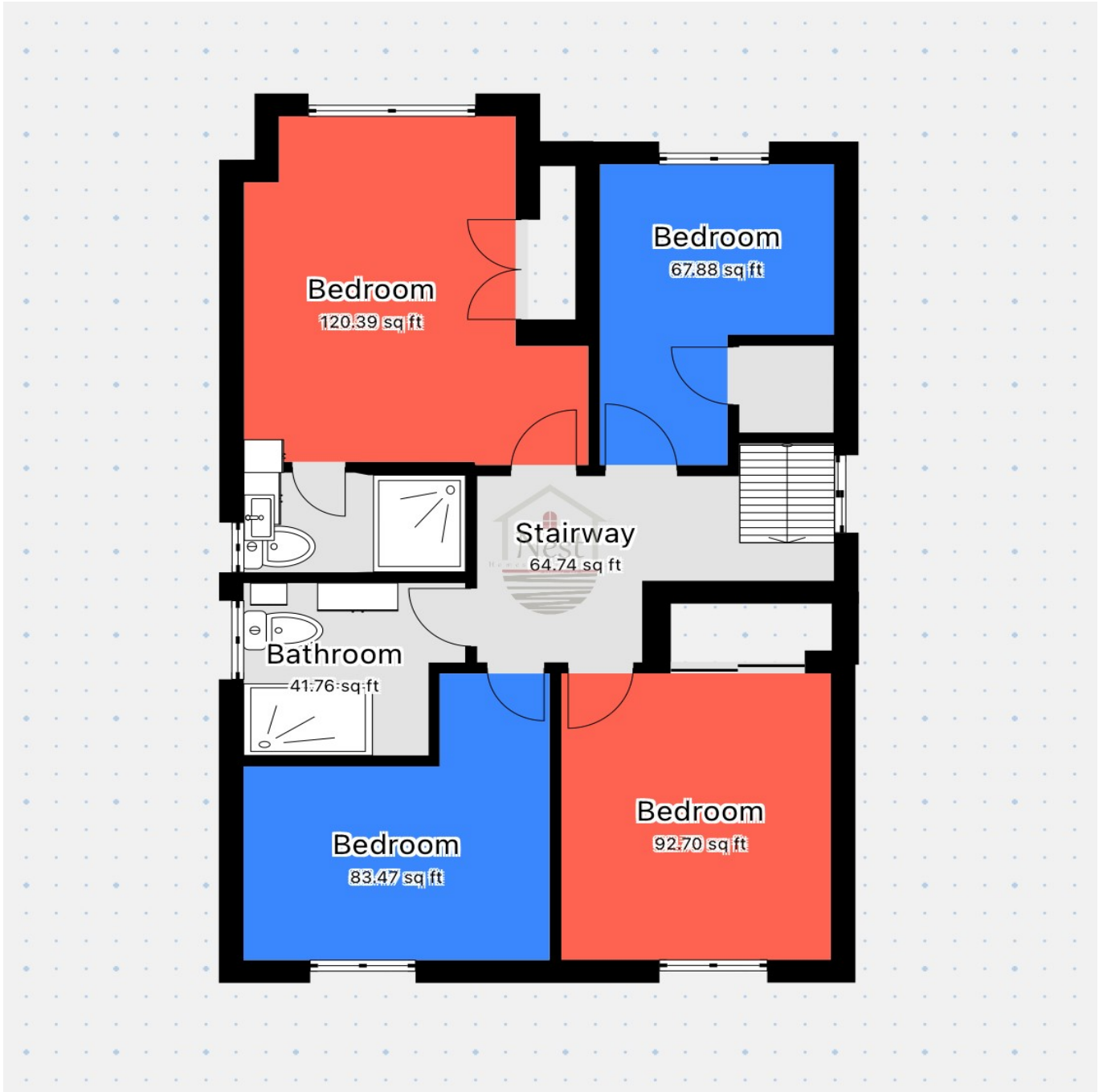

*Floor plan is for illustrative purposes only. Not to scale.*

# Your Renting Journey

We guide you through every step of the process



1

## Arrange a Viewing

Book a viewing at your convenience. We offer in-person and virtual options.

2

## Apply to Rent

Complete our application form and provide references for quick processing.

3

## Referencing

We conduct credit checks, employment verification and landlord references.

4

## Sign Agreement

Review and sign your tenancy agreement. We explain all terms clearly.

5

## Pay Deposit & Rent

Pay security deposit and first month's rent. Deposit protected by scheme.

6

## Move In!

Collect your keys, receive inventory, and enjoy your new home!

Ready to take the next step?

# ARRANGE A VIEWING

Contact our team to book your private viewing:

**Tel: 07304 006532**

**Email: [admin@nest-homes.co.uk](mailto:admin@nest-homes.co.uk)**



Agents notes: All measurements are approximate and for general guidance only and whilst every attempt has been made to ensure accuracy, they must not be relied on. The fixtures, fittings and appliances referred to have not been tested and therefore no guarantee can be given that they are in working order. Internal photographs are reproduced for general information and it must not be inferred that any item shown is included with the property. For a free valuation, contact the numbers listed on the brochure.